

supaBATT™ Install Guide

Application

This installation guide provides installation recommendations for Pink® supaBATT, supplied in batt form in residential wall applications for both new build and retrofit applications. supaBATT is available in both plain and faced with a Vapour Permeable membrane.

Important Notes

- All insulation shall be installed in accordance with AS 3999 & AS 4200.2.
- Refer to the latest ICANZ installation handbook Part 2: Professional Installation Guide for information and tips.
- Ensure that all safety assessments are carried out relevant to the project and all site safety requirements are strictly adhered to.
- Electric cables and equipment partially or completely covered with bulk thermal insulation may overheat and fail. Refer to AS 3999:2015 – Section 2.6 for details.
- Leave a minimum side clearance of 100mm from the body of heat-emitting fixtures such as luminaries, exhaust fans and flues, unless otherwise stated by the manufacturer of the equipment.
- Where cutting is required, use a sharp knife and straight edge. Do not cut insulation with power tools.
- Prior to installation, calculate the amount of insulation and fixings required.
- Pink® insulation products must be installed dry.
- Avoid gaps in the insulation, other than where required, around electrical fittings or as specified.
- Avoid compressing or over fixing insulation. This will reduce the thermal performance of the installed product.
- Avoid using multiple small offcuts to fill single areas. Use larger single pieces, purpose-cut to fill larger gaps.
- Organise to repair damaged plumbing or sewer work before beginning insulation project.
- Turn off the power at the fuse box before commencing the installation. Ensure you place a warning tag to prevent power being restored prior to completion of the install.
- Measure the square metre of area to be insulated.
- Coverages is provided on the relevant Technical Data Sheet.
- Divide the area to be insulated by the coverage per pack to determine the number of packs to order.
- Allow for wastage. As a general rule, allow for 5% wastage for simple areas and greater allowances for more complex areas

Tools



Sharp knife

With a plastic (non-conductive) handle for cutting insulation to size.



Cutting board

Or hard, durable surface.



Staple gun

With non-metallic staples to staple stringing if needed.



Ladder

Or scaffolding as needed.



Tape measure

To measure lengths required.

PPE

Personal Protective Equipment (PPE) must be compliant with the requirements of the specific worksite. Check with site foreman or site representative to ensure that required PPE obligations are met. As a recommendation for handling and installing insulation, the following PPE is recommended:



Eye protection

Suitable eye protection to AS 1336 reduces the risk of eye contact with dust or fibres. Safety glasses must be worn when installing from beneath the ceiling.



Gloves

Gloves are recommended, especially when cutting insulation.

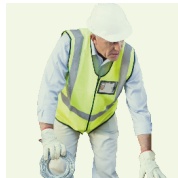

Work clothes

Loose fitting clothes, including long pants, long sleeved shirts, cap and gloves should be worn. Long sleeves recommended.



Dust mask

A dust mask is recommended when working in dusty areas.



Safety shoes

Safety boots/shoes must be worn to protect feet.

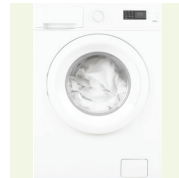

Separate wash

Wash your clothes separately and rinse the washing machine after use.

Safety



Assess

Assess the building structure and site for any safety issues prior to commencing work.



Check

Before entering a ceiling space, make note of the location of equipment in the ceiling such as lighting luminaires, exhaust fans and fire sprinklers.



Electrical wires

Ensure the work area is safe from hazards including electrical cabling. Working near live electrical wiring is extremely dangerous; use caution to avoid touching any live electrical cables.



Isolate power

If accredited, isolate power at the circuit board where necessary and apply caution tags to circuit breakers.



Electrician

If not accredited, ask appropriate site representative to isolate power at the circuit board where necessary and apply caution tags to circuit breakers.



Height

When installing insulation, working at height can be dangerous; exercise caution when climbing ladders or accessing elevated platforms.

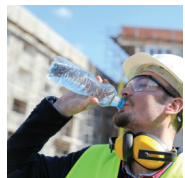

Stay hydrated

Ceiling spaces can be hot and poorly ventilated; get relief and fresh air regularly and stay hydrated.

Stud Framed external walls (Brick Veneer)

- Measure the wall to determine amount of product required.
- Faced supaBATT shall be installed with the white Vapawrap vapour permeable membrane facing externally. Plain, unfaced supaBATT can be installed with any face being external to the building.
- Starting at a corner location install the supaBATT covering the base of the bottom plate. Ensure product is installed continuously across the wall and is abutted and taped at all joins and overlaps.
- The supaBATT shall extend a minimum of 50mm below internal floor height and up to the top of the wall frame.
- Affix using a suitable mechanical fastener with a broad headed washer or plastic pins at a frequency of no more than 150mm centres on timber framing or 300mm on metal studs including the top plate.
- Ensure the select fastener allows for the thickness of the supaBATT.
- Where faced supaBATT is used for areas exceeding the height of the first supaBATT row, ensure that the batts in the second row are cut such that the vapor permeable membrane laps over the top of the first row and is taped and sealed. Where unfaced supaBATT is used butt boards together to minimize any gaps.
- Where faced supaBATT is used Vapawrap facing shall be tape sealed to the top plate in accordance with AS 4200.2
- Where faced supaBATT is used tape and seal all cuts, discontinuities, overlaps, joins, and penetrations using 3M Seaming Tape.
- Where unfaced supaBATT is used, use appropriate Sisalation wall wrap specific to applicable climate zone to cover supaBATT, refer to pliable membrane installation guide for instructions, noting longer staples may be needed. Ensure product is cut to fit tightly around or abutted to penetrations, structural elements and services.

Note: Ensure a 35mm Cavity will be maintained between external façade and supaBATT

Faced SupaBATT

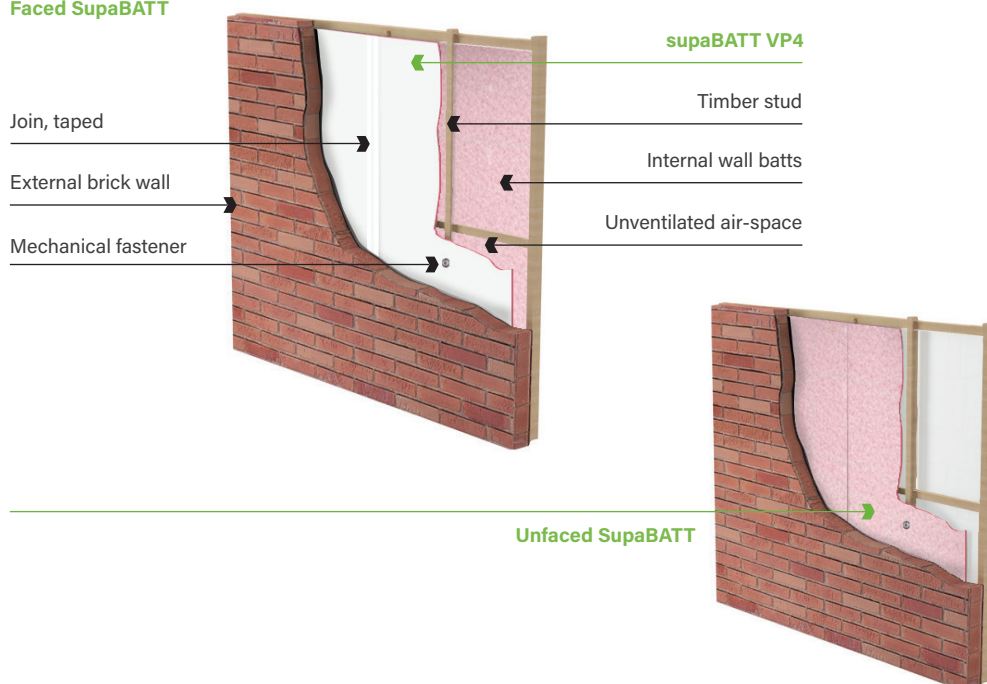

Penetrations

- Any damage made to the Sisalation® vapour permeable building membrane during installation, including holes and tears, must be repaired.
- Off cuts of the membrane may be used to flash below, beside and above a penetration (in this sequence), applying sheets from below the penetration upwards while maintaining suitable overlaps to drain moisture out and away from the building.
- Adhesive tape, such as 3M Seaming Tape, shall be used to seal the penetration, maintaining an air and water tight seal around the service. Refer to Figure 6.
- Tape and seal all overlapped joints, penetrations and discontinuities with 3M Seaming Tape to prevent air movement.
- The Sisalation® vapour permeable building membrane shall be cut back from any hot flue to reduce the fire hazard risk. This can be achieved by allowing for clear space of at least 50mm with non-combustible in-fill of any gaps.

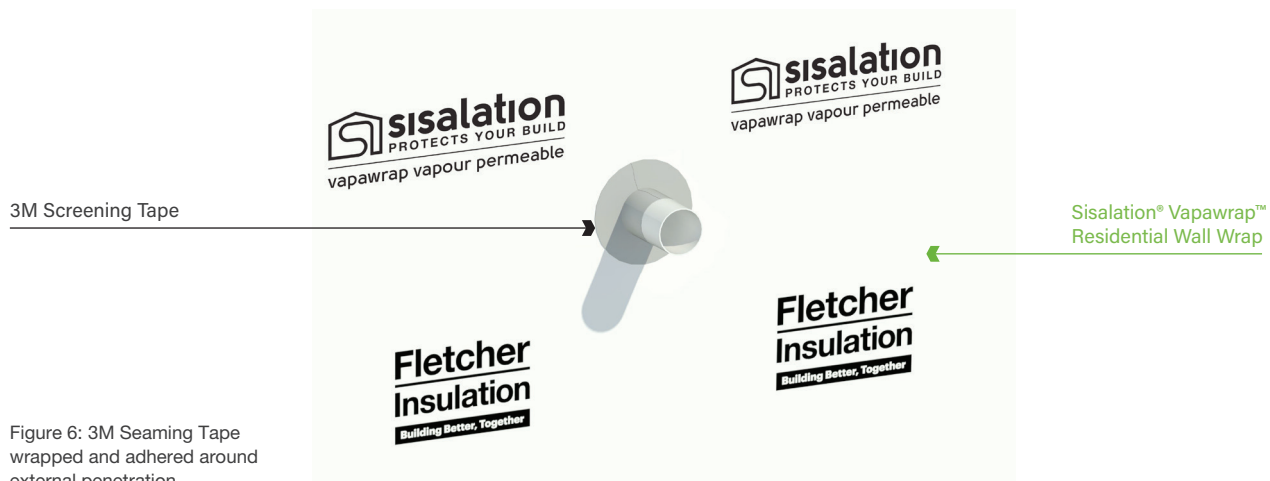

Figure 6: 3M Seaming Tape wrapped and adhered around external penetration.

Note: If your application/installation is outside these guidelines, please contact Fletcher Insulation prior to commencing the install to obtain written approval for your specific application.

© Fletcher Insulation Pty Limited 2024. Fletcher Insulation reserves the right to change product specifications without prior notification. Information in this publication and otherwise supplied to users as to the subject product is based on our general experience and is given in good faith, but because of the many particular factors which are outside our knowledge and control and affect the use of products, no warranty is given or is to be implied with respect to either such information or the product itself, in particular the suitability of the product for any particular purpose. The purchaser should independently determine the suitability of the product for the intended application. The colour PINK, Pink® and Pink® Batts are registered trademarks of Owens Corning used under licence by Fletcher Insulation. FBS-1 Glasswool Bio-Soluble Insulation® is a registered trademark of ICANZ. Unless otherwise stated all ™ and ® are trademarks and registered trademarks of Fletcher Insulation Pty Limited ABN 72 001 175 355. RTDS25_Revision_4_01112024.