



Residential sarking solution

Sisalation® Bubble Cell

Reflective insulation and vapour barrier

One product, many benefits

Sisalation® Bubble Cell is a high quality reflective insulation composite incorporating a triple layer bubble core laminated between multiple layers of tough PE weave and reflective foil laminate. A pink anti-glare coating is applied to one side of the product to reduce the level of glare for installation safety.

Suitable for use as a sarking material in residential and Type C Commercial buildings, Sisalation® Bubble Cell has high quality reflective properties which reduce up to 95% of the sun's radiant heat and allows for cooler internal conditions.

When installed correctly, Sisalation® Bubble Cell reflective insulation minimises the risk of condensation and acts as an effective water and vapour barrier.

Sisalation® Bubble Cell achieves a flammability index of <5, deeming it suitable for use as a sarking membrane in roofs with a Bushfire Attack Level (BAL) of 12.5–40, and walls with a BAL of 12.5–FZ in accordance with AS3959:2018.

Additionally, Sisalation® Bubble Cell achieves an 'Extra Heavy Duty' rating in accordance with Table 1 of AS/NZS4200.1, providing maximum durability and increased tear resistance.

Bubble cell layers

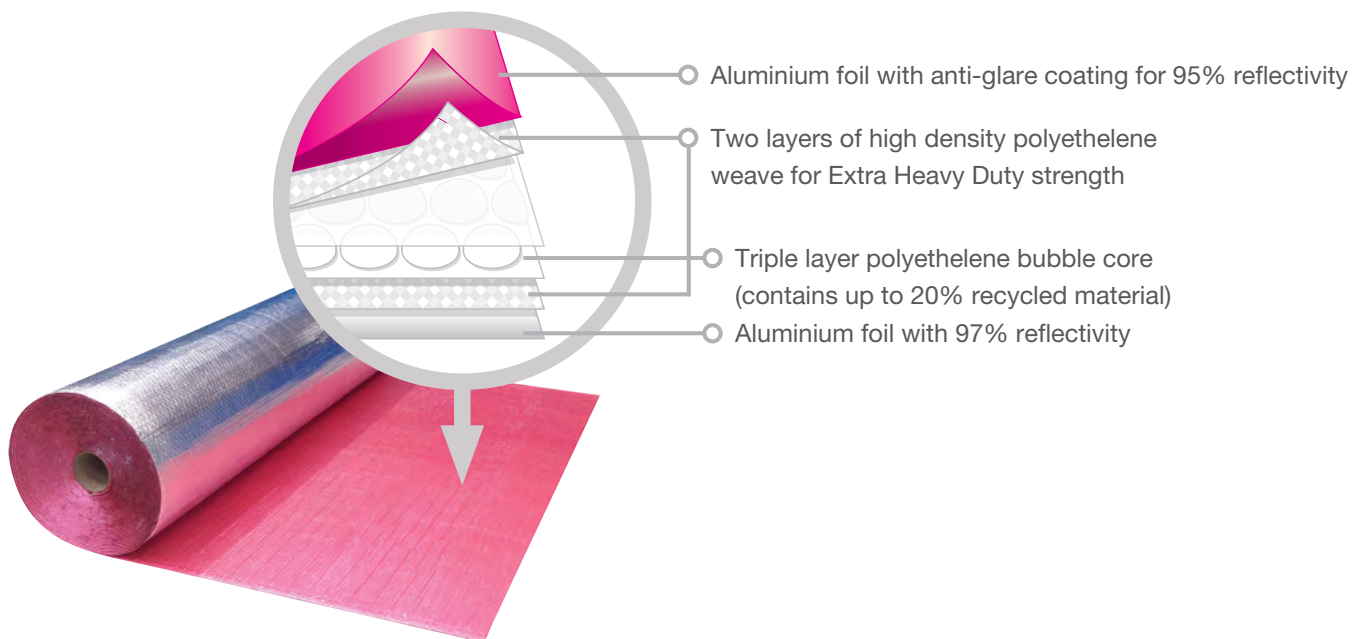

Product features

- A high quality reflective insulation composite which reflects up to 95% of the sun's radiant heat, allowing for cooler internal conditions in hot, humid climates
- Suitable for use as a sarking membrane in both commercial and residential applications
- May be used in roofs with Bush Fire Attack level (BAL) of 012.5–40; and walls with a BAL of 12.5–FZ in accordance with AS 3959:2018
- Maximum durability and increased tear resistance
- Aids in the prevention of condensation
- Allows for easy and rapid installation
- Incorporates an anti-glare coating on one side for added safety during installation
- Fibre free, non-itchy and formaldehyde free insulation

Thermal system properties

	Heat Flow Down	Heat Flow up
Residential metal roof		
Flat ceiling, naturally ventilated*	R2.4	R1.1
Flat ceiling, unventilated*	R2.1	R1.3
Residential tiled roof		
Flat ceiling, naturally ventilated*	R2.0	R1.0
Flat ceiling, unventilated*	R1.7	R1.1
Brick veneer wall		
Plasterboard lining, unventilated*	R1.6	R1.7
Double brick cavity wall		
Unventilated	R1.9	R2.0

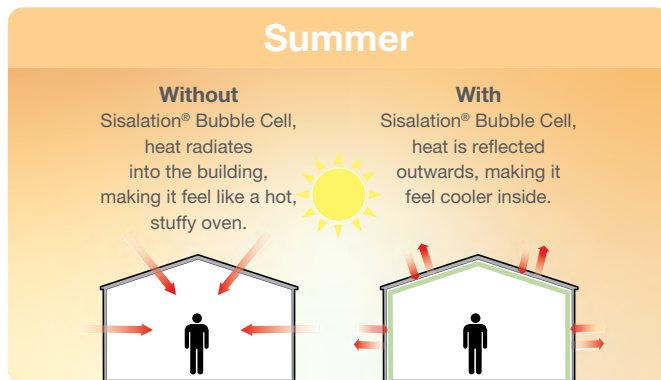
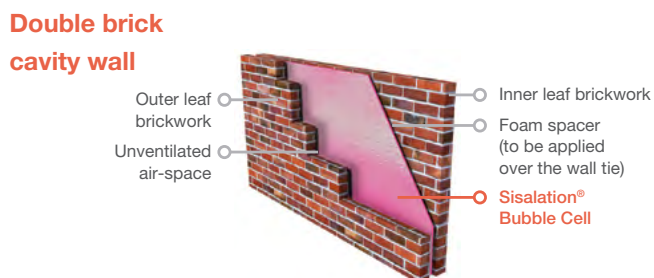
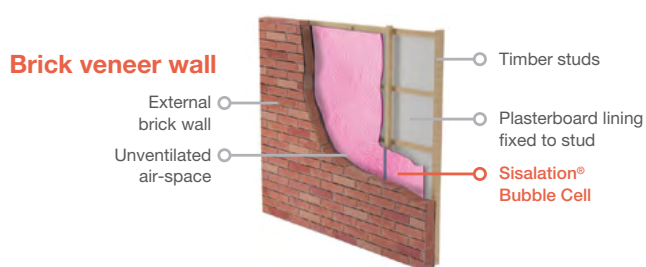
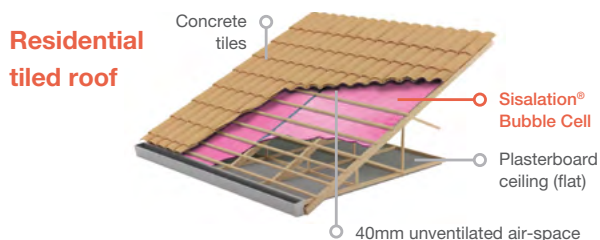
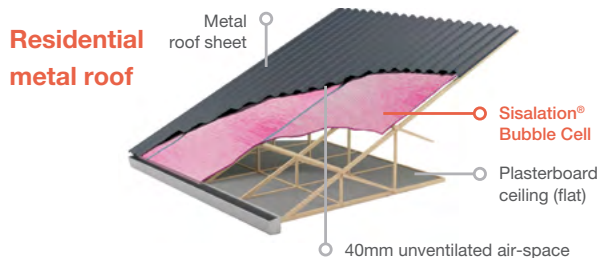

In summer, Sisalation® Bubble Cell helps keep the heat out. Metal roofs can exceed 80°C causing heat to radiate into uninsulated buildings. Sisalation® Bubble Cell greatly reduces this radiation and helps make the building feel much cooler compared to an uninsulated building.

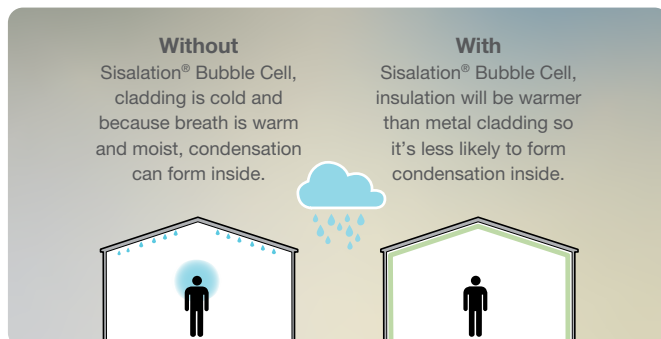
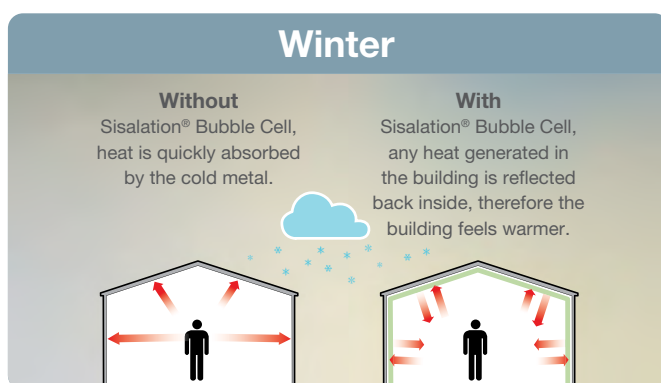

In winter, cold, uninsulated walls quickly remove any heat generated in a building. Sisalation® Bubble Cell will reduce this heat transfer and help make the building feel warmer. It will also reduce the risk of condensation by providing an insulating layer between potentially warm, moist air and the cold wall.

Considering an upgrade? Consider Foam Cell Multipurpose R0.2

Specially designed to meet thermal break requirements for steel framed structures, Sisalation® Foam Cell Multipurpose R0.2 provides increased thermal performance and is the compliant choice each and every time.

*Refer to the relevant diagram for additional construction details. To be installed in accordance with Fletcher Insulation installation guidelines.

Note: the declared Total R-values have been calculated in accordance with the methods outlined in AS/NZS 4859.1. The contribution of this product to the total R-value depends on installation and environmental conditions which includes the effect of dust. The Total R-value will be reduced in the event of the accumulation of dust on upward facing surfaces and in those cavities that are ventilated.

Product data

Sisalation® Bubble Cell reflective insulation is manufactured in Australia to the highest quality standards. Stringent quality and environmental management systems ensure product and process excellence.

Width mm	Length mm	m ² per roll	Nominal weight kg	Product code
1350	22.25	30	14	395215

Physical properties

Property	Test Method/Standard	Result
Thermal Resistance R-value (m ² K/W)	AS/NZS 4859.1	R0.1
Flammability Index	AS 1530.2	≤ 5 (Low)
Group Number		
Early Fire Hazard Indices		
Ignitability Index	AS/NZS 1530.3	0
Spread of Flame		0
Heat Evolved Index		0
Smoked Developed Index		1
Water Control	AS/NZS 4201.4	Water Barrier
Vapour Control	AS 4200.1	Class 2 Vapour Barrier
Emittance (reflective face)	AS/NZS 4201.5	IR Reflective (0.03)
Emittance (anti-glare face)	AS/NZS 4201.5	IR Semi-reflective (0.06)
Duty Classification	AS/NZS 4200.1	Extra Heavy

Environmental properties

No ozone depleting substances were used in the manufacture of Sisalation® Bubble Cell. Specification of Sisalation® Bubble Cell guarantees the use of ODP free insulation while also ensuring that no harmful levels of Volatile Organic Compounds (VOCs) are released. This allows for the incorporation of environmentally preferable insulation whilst also maintaining indoor air quality.

Technical specification

The insulation shall be a Sisalation® Bubble Cell reflective insulation, reflective bubble cell core encapsulated between an upper and lower level of reflective foil laminate with a flammability index of ≤5 and an Extra Heavy Duty rating in accordance with AS/NZS 4200.1. Supplied by Fletcher Insulation, the insulation material shall be installed in accordance with Fletcher Insulation installation guidelines available for download via www.insulation.com.au



© Fletcher Insulation Pty Limited 2022. Fletcher Insulation reserves the right to change product specifications without prior notification. Information in this publication and otherwise supplied to users as to the subject product is based on our general experience and is given in good faith, but because of the many particular factors which are outside our knowledge and control and affect the use of products, no warranty is given or is to be implied with respect to either such information or the product itself, in particular the suitability of the product for any particular purpose. The purchaser should independently determine the suitability of the product for the intended application. The colour PINK, Pink® and Pink Batts® are registered trademarks of Owens Corning Intellectual Capital, LLC used under licence by Fletcher Insulation. FBS-1 Glasswool Bio-Soluble Insulation® is a registered trademark of ICANZ. Unless otherwise stated, all ™ and © are trademarks and registered trademarks of Fletcher Insulation Pty Limited ABN 72 001 175 355. BR29_Revision_2_Issue_Date_01112022.

Customer Service Phone
1300 654 444
Email: info@insulation.com.au
www.insulation.com.au